

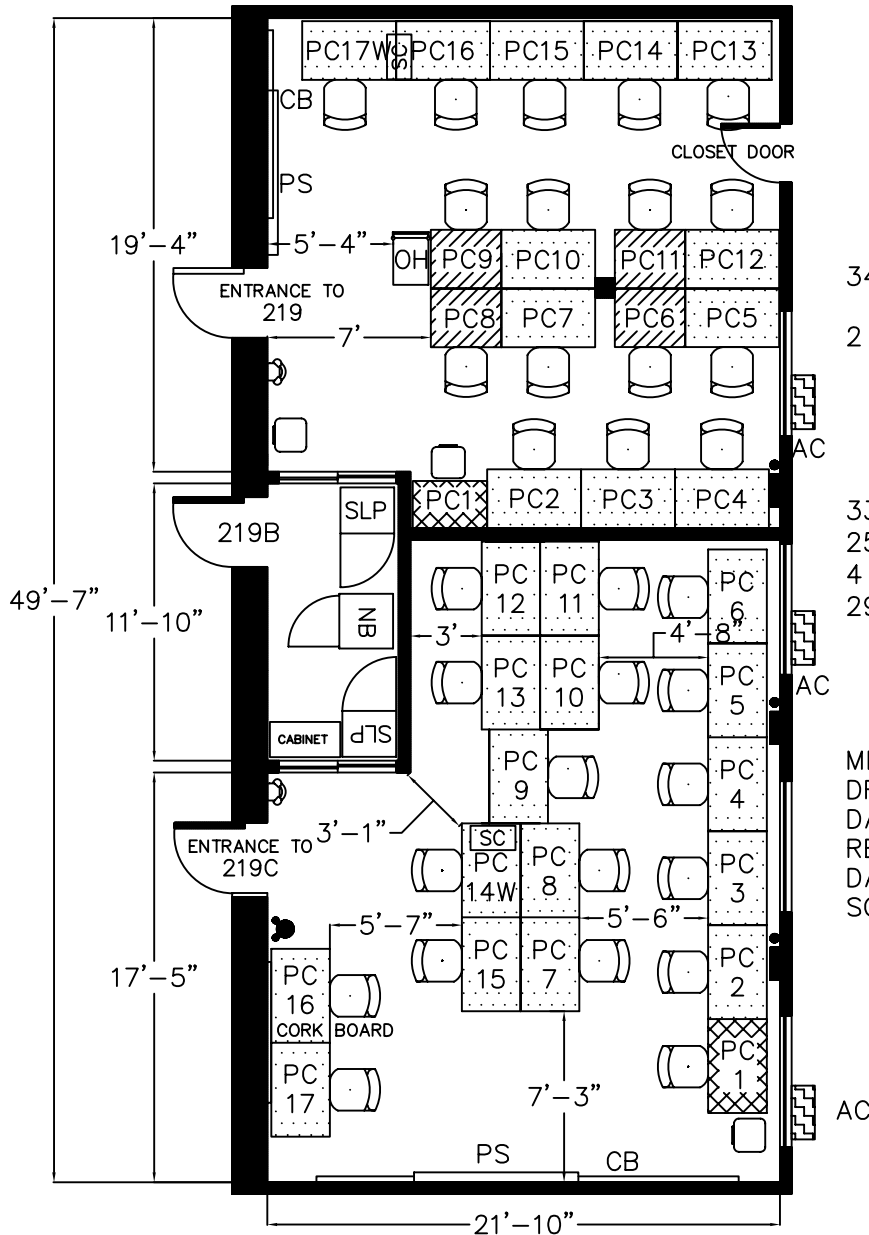

219 & 219C N. KEDZIE COMPUTER LABS



LEGEND

- 34 PC PENTIUM COMPUTER
(17 IN EACH LAB)
- 2 W WHEELCHAIR ACCESSIBLE STATION
- OH OVERHEAD PROJECTOR
- PS PROJECTION SCREEN
- AC AIR CONDITIONER
- NB NETWORK BOX
- SLP SELF SERVE LASER PRINTER
- 33 ERGONOMIC CHAIR
- 25 STACKING CHAIR
- 4 3' X 2'-6" TABLE
- 29 4' X 2'-6" TABLE
- INSTRUCTOR STATION
- TELEPHONE
- SC SCANNERS LOCATED AT PC 17 & PC 14

MICHIGAN STATE UNIVERSITY
 DRAWN BY: JAMIE RIOS
 DATE: OCTOBER 30, 1996
 REVISED BY: CHRISTINA HEINS
 DATE: JUNE 29, 2005
 SCALE: NO SCALE

- * 219: 460 SQ. FT., 219B: 66 SQ. FT., 219C: 536 SQ. FT.
- * AIR CONDITIONED
- * WALL MOUNTED PHONE FOR HELP-LINE CONSULTING
- * CEILING MOUNTED DATA PROJECTOR IN 219 & 219C